

上流式蒸餾水機

MODEL SP-A21T-R600a

請妥善保管本說明書
使用飲水機前請仔細閱讀說明書內容

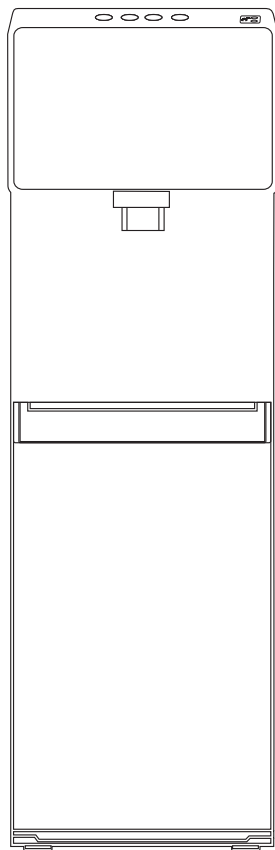

目錄

一：安全指引.....	2
二：開始使用.....	4
三：部件名稱.....	5
四：饮水.....	6
五：故障自检.....	7
六：清洗指南.....	7
七：脚架安装.....	8
八：技术参数.....	8

一、安全事項



為了減少傷害的危險和財產的損失，用戶在裝配、安裝和操作飲水機前必須完整的閱讀本指南。

未能按照本手冊中說明操作，可能導致人身傷害或財產損失。

本產品流出非常高溫的水。

如果不正確使用，可能導致人身傷害。

當使用此飲水時，須執行以下的基本安全防範措施：

- 在使用之前，必須按照本手冊正確組裝和安裝飲水機。這飲水機的目的是提供飲水功能。不要裝入其他液體。不做其他用途。除了已知的、微生物性安全的瓶裝水外，不要裝其他液體到本飲水機。
- 只能在室內使用。把飲水機放在不被陽光直射和乾燥的地方。不要在戶外使用。
- 只在堅硬、平坦的表面安裝和使用。
- 不要把飲水機放入封閉的空間或櫃子里。
- 不要在有爆炸性氣體的地方使用飲水機。
- 放置飲水機的背部離牆不少於 20cm，以便飲水機和牆之間的空氣自由流通。
- 只使用接地線的插座。
- 不要給你的飲水機的電源線增加延長線。
- 如要拔出插頭，請直接抓住插頭，從插座上拔出。不要通過拉電源線拔掉插頭。
- 如果電源線磨損或損壞，不使用飲水機。
- 為防止觸電，不要沉浸電源線、插頭，或飲水機的任何其他部份於水或其他液體中。
- 清潔飲水機之前請確保拔下電源線。
- 勿讓子女在沒有適當和直接的監督下盛接熱水。
- 須由經過認證的技術人員維護。
- 注意：莫損壞製冷回路。

- 成人應監督孩子們，以確保兒童不玩弄該設備。
- 該設備不適宜給身體、感官或精神有殘缺的人（包括孩童）或是缺乏經驗和知識的人直接使用，除非有負責他們安全的人的監督或接受了使用該設備的指導。
- 此設備適用於家庭及以下場所：商店裡的員工廚房、辦公室和其他工作場所。農莊、酒店、旅館和其他居住環境、起居飲食環境。
- 如果飲水機電源軟線損壞，為避免危險，必須由製造商、其維修部或類似的部門專業人員來更換。
- 勿把飲水機上下倒置或者是傾斜 45 度以上。
- 溫控器已調好，無需你再調整。當機器溫度低於冰點並被冰阻塞，冷卻開關必須關上 4 個小時再開通以繼續使用。
- 關閉該機器 3 分鐘之後才能再重新打開。
- 請勿在本水機內放置易燃易爆物體，如盛放了易燃氣體的噴霧罐等。

二、開始使用

放置飲水機

- 1、直立放置飲水機
- 2、把飲水機放置在堅固的水平面上。同時確保附近有接地線的插座並且環境陰涼。

注意：此時且勿插電源線

- 3、飲水機的背部和牆體間留有至少 20cm，兩側的間隙至少要有 20cm。

組裝

- 4、從櫃門移下滴水託盤，再把格網放到滴水託盤上。
- 5、把滴水託盤和格網組件按到櫃門上

安裝水桶

- 1、打開飲水機的櫃門。
- 2、把吸水組件安到掛架上。
- 3、把新的水桶放到櫃旁邊。
- 4、移除水桶口上的整個塑膠套。
- 5、用布清潔水桶口的外部。
- 6、將吸水管伸進桶裏。
- 7、將吸水管套圈壓緊至瓶口。
- 8、將吸水管的接頭壓下，直到水管接觸到桶的底部。
- 9、將水桶移入櫃內。



電源

將電源線接到有正確接地的牆壁插座上。此時，泵將開始把水從水桶抽到熱罐和冷罐裏，若是第一次使用，將需要 5 分鐘以填滿儲水箱。在此期間，泵將持續運行。這是正常的。

啟動加熱和製冷

提示：在開關未被開啟時，該設備將不會流出熱水或冷水。接下機背頂部的製冷制熱開關，開始加熱或製冷。

如果你不想加熱水，可推下紅色開關至底部關閉熱水開關。

如果你不想制冷水，推下綠色開關至底部關閉冷水開關。

三、部件名稱

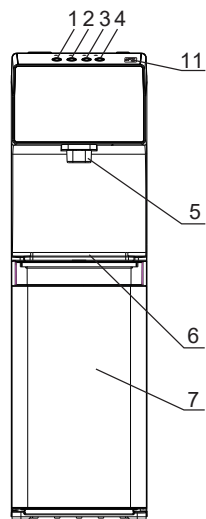

(前)

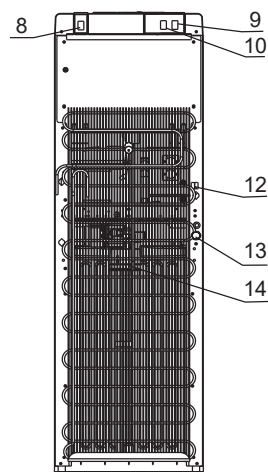

(背)

序號	零件名稱	序號	零件名稱
1	兒童安全鎖按鈕	8	夜燈開關
2	熱水按鈕	9	加熱開關
3	溫水按鈕	10	製冷開關
4	冷水按鈕	11	免接觸圖示
5	出水口	12	電源線
6	集水器	13	熱水排水口
7	門	14	冷凝器

註：

適宜使用 5 加侖的桶裝水。不應使用不健康硬水。

四、飲水

本機在包裝和運輸前已通過測試和消毒。在運輸過程中，灰塵和氣味可能積累在水箱和管道裡。在喝任何水之前，倒出並丟棄至少一夸脫的水。

飲用冷水

開機後，飲水機需要 1 個小時已達到最大的製冷效果。在此期間，壓縮機可能持續運行。這是正常的。

- 1、把水壺、水杯、水瓶或烹飪鍋放到出水口下。
- 2、向下壓低冷水控制以使冷水流出。
- 3、一旦達到想要的水量就鬆開控制。

飲用熱水（開機后，熱水機需要 15 - 20 分鐘）

- 1、把水壺、水杯、水瓶或烹飪鍋放到出水口下。
- 2、把紅色按鈕往你的反方向推，向下壓低熱水控制以使熱水流出。
- 3、一旦達到想要的水量就鬆開控制。

更換水桶

功能燈會閃爍紅燈提醒你當水桶空了。儘快更換水桶。

提醒：當紅燈閃爍時，不要倒出熱水、涼水或冷水。因為這樣會使水箱空了並導致飲水機過熱。

- 1、打開飲水機櫃門。
- 2、把空水桶移出櫃子。
- 3、把探頭移出空水桶。把探頭組件放在探頭掛架上。
- 4、把空水桶放一邊。
- 5、把新的水桶放到櫃旁邊。移出水桶口上的整個塑膠套。用布清潔水桶口的外部。
- 6、將探頭伸進桶裏。將套圈向下移直到到位。將探頭的接頭向下，直到水管接觸到桶的底部。
- 7、將水桶移入櫃內。並關上櫃門。

無接觸控制功能

將你的手掌置於無接觸圖示下方的感應器上方 2 英寸處，以接取冷水。接水將在 1.5 秒後開始，並持續長達 30 秒。設定模式：同時按住兒童安全鎖按鈕和熱水按鈕 3 秒，兒童安全鎖按鈕和冷水按鈕的燈會閃爍。若你未採取任何行動，10 秒後無接觸控制功能將關閉。若你將手掌覆蓋兩個感應器，兒童安全鎖按鈕和冷水按鈕的燈將保持常亮。保持手掌（覆蓋狀態）以重新開啟無接觸功能，並設定持續接水時間為 0 到 40 秒。關機後將恢復為預設設定。

五、故障自检

漏水

拔掉水機電源，移開水桶並替換。

出水口沒有水出

檢查水瓶內的水是否用完，如果用完，更換水桶。確保控制按鈕已完全開啟。

冷水不冷

安裝後，需起碼啟動一個小時才有足夠冷的水。

確保電源線是否正確連接到了可正常使用的電源插座。

確保飲水機離牆之間留有至少 20cm，以便水機與牆有 20cm 的空氣流通。

確保綠色電源按鈕為開啟。如果冷水依然不冷，請要求服務代理提供援助。

熱水不熱

安裝後，熱水需加熱 10 - 20 分鐘。

確保電源線是否正確連接到了可正常使用的電源插座。

確保飲水機後面的紅色電源開關是開啟狀態。

水機有噪音

確保水機被正確安置在水平面上。

六、清洗指南

為避免意外，請依照下列說明在操作前切斷電源供應。

1、此機器在出廠前已消毒。首次安裝滿瓶的水之前，請清潔飲水機。

2、清潔與排水說明：

a) 清潔前，確保電源開關處於「O（關閉）」位置，並拔下飲水機的插頭。

b) 擰出兩顆螺絲①，然後取下頂蓋、冷水箱蓋與分隔器②。

c) 將 0.6 加侖的純水注入冷水箱以清潔它。

d) 在飲水機背面的排水口下方放置一個大水桶，然後移除排水蓋並排水③。

e) 排水後，重新放置排水蓋、分隔器、冷水箱蓋與頂蓋。確保管子與線路連接妥當，之後，你即可正常使用機器。

注意：1) 清潔必須在專業人員的指導下進行。

2) 飲水機將水加熱到約 85°C 的溫度。這可能會造成嚴重燙傷。請小心操作。

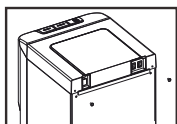

①

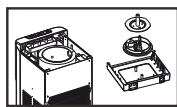

②

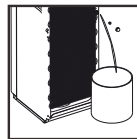

③

3、消毒

應使用從藥局或市場另外購買的消毒劑，依照消毒劑的使用手冊對機器進行消毒，然後用水清潔（請參閱清潔與排水說明）。一般來說，每三個月應進行一次。

4、去除礦物沉積物：

將 4 公升的水與 200 克的檸檬酸晶體混合，注入機器中，並確保水可以從熱水龍頭流出。打開電源，加熱約 10 分鐘，30 分鐘後，排出液體，並用水清洗兩到三次。一般來說，每六個月應進行一次。

切勿自行拆卸此機器，以避免因機器損壞而造成危險。

七、腳架安裝

- 1 - 2、如圖所示，鬆開左下角或右下角的螺絲。
- 3、用螺絲將支架固定在飲水機的左下角或右下角。
- 4、在將要安裝飲水機的地板或桌面鑽一個孔。
- 5、用螺絲將支架緊固在地板上。
- 6、擰緊螺絲。

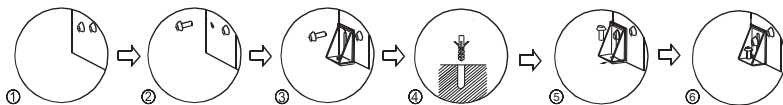
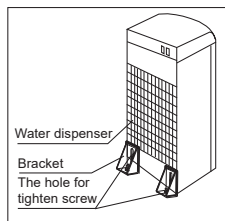

警告！

為避免因設備不穩定而導致危險，必須依照說明書的指示將其固定。

八、技术参数

項目機型	SP-A21T-R600a
額定電壓	220-240V~
額定頻率	50/60Hz
額定功率	500W
加熱功率	420W
製冷電流	1.0A
熱水	4L/h(≥85°C)
冷水	2L/h(≤10°C)
製冷劑	R600a(14g)
產品尺寸	310*360*1040mm
包裝尺寸	358*396*1120mm

註：生產商保留更改之權利而不作另行通知

本產品所使用的包裝材料都是可回收的。我們建議您單獨將塑膠、紙張和紙板交到回收站，以助環境保護。產品使用的是製冷劑 R600a（氫氟烴 - HFC），其不影響臭氧層，對溫室效應的影響不大。根據 WEEE 準則（電氣與電子設備廢物），電氣和電子設備廢棄物應單獨收集。如果將來您需要處置本產品，請不要與您的生活垃圾一同廢棄。而請將產品送至最近的 WEEE 收集點，如果有的話。



Bottom Loading Water Dispenser

MODEL SP-A21T-R600a

KEEP THIS MANUAL IN GOOD CONDITION
PLEASE READ THIS MANUAL CAREFULLY
BEFORE USING THE MACHINE
REV.

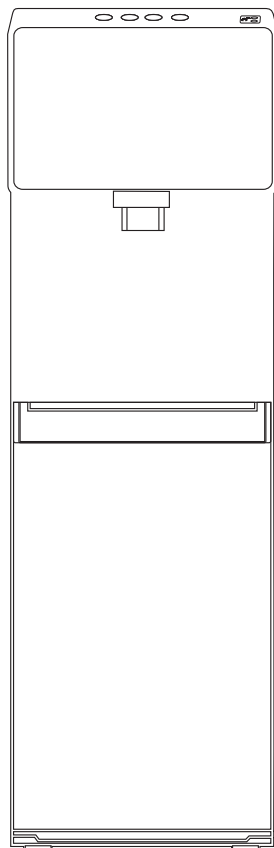

DIRECTORY

A: SAFETY INSTRUCTION.....	2
B: GETTING STARTED.....	4
C: PART NAME.....	5
D: DISPENSING WATER.....	6
E: TROUBLE SHOOTING.....	7
F: CLEANING.....	7
G: MACHINE INSTALLATION.....	8
H: TECHNICAL PARAMETRES.....	8

A: SAFETY INSTRUCTION

WARNING

To reduce risk of injury and property damage, user must read this entire guide before assembling, installing & operating dispenser.

Failure to execute the instructions in this manual can cause personal injury or property damage. This product dispenses water at very high temperatures. Failure to use properly can cause personal injury. When operating this dispenser, always exercise basic safety precautions, including the following:

- Prior to use, this dispenser must be properly assembled and installed in accordance with this manual.
- This dispenser is intended for water dispensing only. Do NOT use other liquids.
- Do NOT use for other purposes. Never use any other liquid in the dispenser other than known and microbiologically safe bottled water.
- For indoor use only. Keep water dispenser in a dry place away from direct sunlight. Do NOT use outdoors.
- Install and use only on a hard, flat and level surface.
- Do NOT place dispenser into an enclosed space or cabinet.
- Do NOT operate dispenser in the presence of explosive fumes.
- Position back of dispenser no closer than 20cm from wall and permit free airflow between wall and dispenser. There must be at least 20cm clearance on the sides of the dispenser to permit airflow.
- Use only properly grounded outlets.
- Do not use an extension cord with your water dispenser.
- Always grasp plug and pull straight out from outlet. Never unplug by pulling on power cord.
- Do NOT use dispenser if cord becomes frayed or otherwise damaged.
- To protect against electric shock, do NOT immerse cord, plug, or any other part of dispenser in water or other liquids.
- Ensure dispense is unplugged prior to cleaning.
- Never allow children to dispense hot water without proper and direct supervision. Unplug unit to prevent unsupervised use by children.
- Service should be performed only by a certified technician.
- Warning: Do not damage the refrigerant circuit.
- This appliance can be used by children aged from 8 years and above if they have been given supervision or instruction concerning use of the appliance in a safe way and if they understand the hazards involved. Cleaning and user maintenance shall not be made by children unless they are older than 8 and supervised. Keep the appliance and its cord out of reach of children aged less than 8 years.
- Children should be supervised to ensure that they do not play with the appliance.
- This appliance is intended to be used in household and similar applications such as: staff kitchen areas in shops, offices and other working environments; farm houses and by clients in hotels, motels and other residential type environments; bed and breakfast type environments; catering and similar non-retail applications.
- If the supply cord is damaged, it must be replaced by the manufacturer, its service agent or similarly qualified persons in order to avoid a hazard.
- The appliance must not be cleaned by a water jet.
- The appliance is suitable for indoor use only.
- WARNING: Keep ventilation openings, in the appliance enclosure or in the built-in structure, clear of obstruction.
- WARNING: Do not use mechanical devices or other means to accelerate the defrosting process, other than those recommended by the manufacturer.
- Do not store explosive substances such as aerosol cans with a flammable propellant in this appliance.

- This appliance should work under environment of temp from 4°C~40°C.
 - This appliance is not suitable for installation in an area where a water jet could be used.
 - Never turn the machine upside down or lean it more than 45°.
 - When the machine is under the ice point and blocked by ice, the cooling switch must be closed for 4 hours before turning it on again to continue its operation.
 - This machine should not be turned on until 3 minutes later after turning off the power switch.
 - WARNING : UV radiation is dangerous for eyes and skin. do not operate the UV-C emitter outside the appliance.
 - WARNING : Do not operate the UV-C emitter when it is removed from the appliance enclosure;
 - WARNING : This appliance contains a UV emitter. Do not stare at the light source.
 - Unintended use of the appliance or damage to the housing may result in the escape of dangerous UV-C radiation UV-C radiation may even in little doses cause harm to the eyes and skin.
 - Appliance the are obviously damaged must not operated.
- If the replacement of the UV-C emitter by the user is not allowed, this must be clearly stated.

B:GETTING STARTED

Locate Dispenser

- 1.Place dispenser upright.
- 2.Locate dispenser on a hard and level surface in a cool shaded location near a grounded wall outlet.

Notice: Do NOT plug in power cord yet.

- 3.Position dispenser so the back is at least 20cm from wall and there are at least 20cm of clearance on both sides.

Assemble

- 1.Remove drip tray from door and place the grid on top.
- 2.Snap drip tray and grid assembly into door.

Install Water Bottle

- 1.Open dispenser door.
- 2.Place probe assembly on probe hanger.
3. Place fresh bottle outside of cabinet.
4. Remove entire plastic cap from top of bottle.
5. Clean outside of new bottle with a cloth.
- 6.Place probe into bottle.
- 7.Slide collar down until it clicks in place.
- 8.Push head down until tubes hit bottom of bottle.
- 9.Slide bottle into cabinet and close door.



Provide Electricity

Plug cord into a properly grounded wall outlet. At this time the pump will begin to move water from the bottle to the hot and cold tanks.

It will take up to 5 minutes to fill the tanks for the first time.

During this period the pump will run continuously. This is normal.

Activate Heating & Cooling

Notice: This unit will not dispense hot or cold water until the switches are activated.

To activate, push top side of power switches in to start heating and cooling water.

-If you do not want to heat water, push bottom side of red switch in.

-If you do not want to cool water, push bottom side of green switch in.

C: PARTS NAME

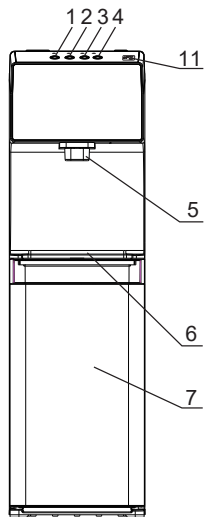

(FRONT)

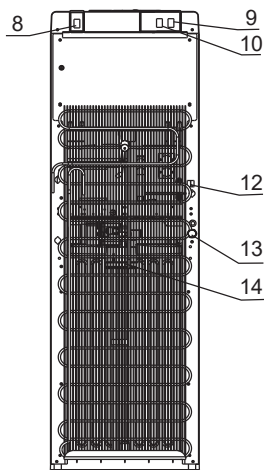

(REAR)

NO.	PART NAME	NO.	PART NAME
1	Child lock button	8	Night light switch
2	Hot water button	9	Heating switch
3	Warm water button	10	Cooling switch
4	Cold water button	11	Touchless icon
5	Water faucet	12	Power cord
6	Water collector	13	Hot water outlet
7	Door	14	Condenser

NOTE:

This machine is suitable for bottle of 5 gallons. Don't use unhealthy hard water.

D: DISPENSING WATER

This unit has been tested and sanitized prior to packing and shipping. During transit dust and odors can accumulate in the tank and lines. Dispense and dispose at least one quart of water prior to drinking any water.

Dispensing Warm or Cold Water

1. Water will take approximately 1 hour after initial set up to become completely chilled. Cooling light will turn off once the water has been fully chilled.
2. Press cold/warm water button to dispense cold/warm water
3. Release button once desired fill level is achieved.

Dispensing Hot Water

1. Water will take approximately 15-20 minutes after initial set up to reach its hottest temperature. Heating light will turn off once the water has been fully heated.
2. This water dispenser is equipped with a child safety feature in order to prevent inadvertent dispensing. To enable dispensing of hot water, press the child lock button first, then press the hot water button.
3. Release button once desired fill level is achieved.

CAUTION: This unit dispenses water at temperatures that can cause severe burns. Avoid direct contact with hot water. Keep children and pets away from the unit while dispensing. Never allow children to dispense hot water without proper and direct supervision. Disable the heating feature by switching the heating convenience switch.

Changing Bottles

A flashing red light on your function lights alerts you when your bottle is empty. Replace the bottle as soon as possible

Notice: Do not dispense hot or cold water if the red light is flashing as you could empty the tanks and cause the dispenser to overheat.

1. Open dispenser door.
2. Slide empty bottle out of cabinet.
3. Remove probe assembly from empty bottle. Place probe assembly on probe hanger.
4. Set empty bottle aside.
5. Place fresh bottle outside of cabinet. Remove entire plastic cap from top of bottle. Clean outside of new bottle with a cloth.
6. Place probe into bottle. Slide collar down until it clicks in place. Push head down until tubes hit bottom of bottle.
7. Slide bottle into cabinet and close door.

Touchless control function

Place the palm of your hand 2 inches over the sensor below the touchless icon to dispense cold water. Dispensing will begin after 1.5 seconds and continue for up to 30 seconds.

Setting model: Press the child lock button and hot water button 3s together, the child lock button and cold water button light flash. The touchless control function will be closed in 10 seconds if you don't take any action. If you put your palm over the two sensors, the child lock button and cold water button light will become keep on. Hold your palm to re-start the touchless function and set the continue water dispensing time from 0 to 40 seconds. Power off will resume to default setting.

E: TROUBLE SHOOTING

Water is leaking.

- Unplug dispenser, remove bottle and replace it.

No Water is coming from the spout.

- Make sure the bottle is not empty. If empty, replace it.
- Make sure to completely depress the pushbutton controls.

Cold water is not cold.

- It takes up to one hour after setup to dispense cold water.
- Make sure the power cord is properly connected to a working outlet.
- Make sure the back of the dispenser is at least 20cm from a wall and there is free airflow on all 20cm sides of the dispenser.
- Make sure green power switch on back of dispenser is ON.
- If water still isn't cold, please ask for the service agent for assistance.

Hot water is not hot.

- It takes 15-20 minutes after setup to dispense hot water.
- Make sure the power cord is properly connected to a working outlet.
- Make sure red power switch on back of dispenser is ON.

Dispenser Is Noisy

- Make sure the dispenser is positioned on a level surface.

F: CLEANING

To avoid accident, cut off the power supply before operation according to the following instruction.

1.The machine had been disinfected before departed from factory. Cleaning the dispenser prior to install a full bottle of water for the first time.

2.Cleaning and draining instruction:

- a) Before cleaning, make sure the power switch in the O(off) position and unplug the water dispenser.
- b) Twist out the two screws①, then take down top cover, cold tank cover and separator②.
- c) Fill 0.6 gallons pure water into cold tank to clean it.
- d) Place a large water bucket beneath the drain outlet which on the back of water dispenser, then remove the drain cover and drain the water③.
- e) Reposition the drain cover, separator, cold tank cover and top cover after draining. Ensure the pipe and wires are connected properly, then, you can use the machine normally.

Attention: 1) The cleaning must be under the guidance of professional staff.

2)The dispenser heats water to a temperature of approximately 85℃. It can cause severe burns. Please operate it carefully.

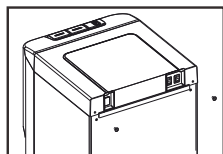

①

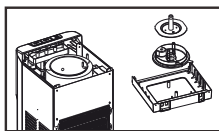

②

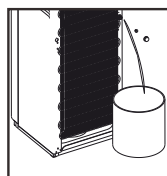

③

3.Sanitizing

The machine should be disinfected with the disinfectant separately bought from drugstore or marketplace according to the instruction manual of the disinfectant and then clean it with water (see cleaning and draining instruction). Generally this should be done every three months.

4.To remove mineral deposits:

Mix 4 liters water with 200g citric acid crystals, inject into the machine and make sure the water can flow out of the hot water tap. Switch on the power and heat it about 10 minutes, 30 minutes later, drain off the liquid and clean it with water for two or three times. Generally this should be done every six months.

Never disassemble this machine by yourself to avoid danger from damaged machine.

G: MACHINE INSTALLATION

- 1-2. Loosen the screw of the left or right bottom angle just as the picture shown.
- 3.Use the screw to fix the bracket on the left or right bottom angle of the water dispenser.
- 4.Make a hole on the floor's or the desk's surface where the water dispenser will be installed.
- 5.Fix the bracket on the floor by screw tightly.
- 6.Tighten the screw.

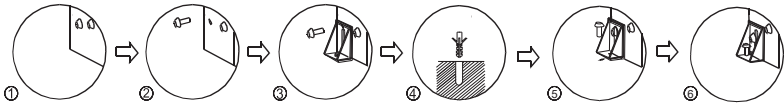
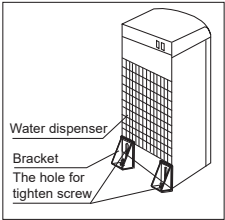

WARNING! To avoid a hazard due to instability of the appliance, it must be fixed in accordance with the instructions.

H: TECHNICAL PARAMETRES

MODEL	SP-A21T-R600a
RATED VOLTAGE	220-240V~
RATED FREQUENCY	50/60Hz
RATED POWER	500W
HEATING POWER	420W
COOLING CURRENT	1.0A
HOT WATER	4L/h(≥85°C)
COLD WATER	2L/h(≤10°C)
REFRIGERANT	R600a(14g)
PRODUCT DIMENSIONS	310*360*1040mm
PACKING DIMENSIONS	358*396*1120mm

The packaging material used is recyclable; we recommend that you separate plastic, paper and cardboard and give them to recycling companies. To help preserve the environment, the refrigerant used in this product is R600a, which does not affect the ozone layer and has little impact on the greenhouse effect. According to WEEE (Waste of Electrical and Electronic Equipment) guidelines, waste from electrical and electronic devices should be collected separately. If you need to dispose of this appliance in the future, do NOT throw it away with the rest of your domestic garbage. Instead, please take the appliance to the nearest WEEE collection point, where available.

